

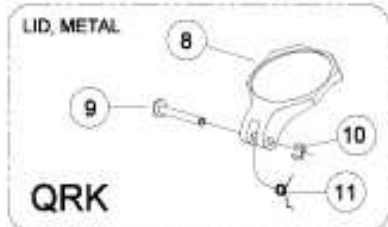

QB3 / QB5 / QB7

25040 - 25020 - 25003

3/4" - 1-1/2" one piece quick coupler valves



OR

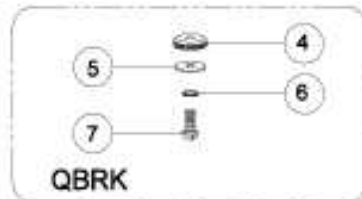
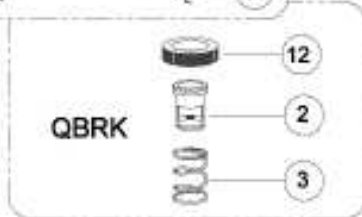
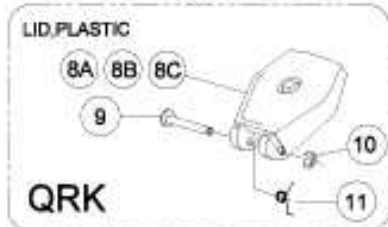

QBRK Repair Kit:
 2 Plunger
 3 Spring
 4 Rubber Seat
 5 Washer s/s
 6 Washer fiber
 7 Screw
 12 Seal

QRK Lid Repair Kit
 8 Brass Top
 8A Yellow Tuff-Top
 8B Locking Yellow Tuff-Top
 8C Purple Non-Potable Locking Tuff-Top
 9 Pin
 10 E-Clip
 11 Lid Spring

Items sold separately :
 13 Body

QCV Trouble Shooting Tips
 All valves should be installed with gravel sumps surrounding and under the valve for adequate drainage.

1. Water leaks around valve:
 - A. Check QCV key part number to make sure it is compatible with the QCV.
 - B. Check U-Cup seal (#12) for wear or damage. Replace as necessary.
 - C. Check key for wear, pits, cracks, etc.
 - D. Check inside valve for obstructions: rocks, twigs, leaves, etc.
2. Valve leaks constantly:
 - A. Check valve for obstructions.
 - B. Check rubber seat (#4) for wear or damage. Replace as necessary.
 - C. Check installation. Make sure valve is not cross-threaded onto riser and all other connections are water-tight. Use teflon tape on all threads (#7). Never use teflon paste near valves.

	QCV Model #		
	3/4"	1"	1-1/2"
Brass Cover	QB3BL07, QB35BL07	QB5BL10	QB7BL15
Yellow Tuff-Top	QB3RC07	QB5RC10	QB7RC15
Locking Yellow Tuff-Top	QB3LRC07	QB5LRC10	QB7LRC15
Non-Potable Purple Locking Tuff-Top	QB3NP07	QB5NP10	QB7NP15
Body (NPT)	504150	500028	500032
Body (BSPT)	504154	501385	501386

KITS ON BACK.

Buckner by STORM 4381 N. Brawley Ave., Fresno, CA 93722 (559) 275-0500 Customer Service (800) 328-4469

502630